

## Model SF-DN4 Digital Audio to Network Interface

- Converts Two Left/Right Digital Audio Sources to Four Dante Network Audio Signals
- AES/EBU or S/PDIF Coaxial or Optical Inputs
- Supports Input Sampling Rates from 44.1 kHz to 192 kHz
- Selectable Dante Sample Rates: 44.1 kHz, 48 kHz, 88.2 kHz, 96 kHz
- Digital Signal Lock Indicator for Valid Inputs
- Transformer-Isolated AES/EBU Input
- Digital Audio Sources Remain in the Digital Domain through the Dante Network Output
- Special Software Not Required for Module Setup
- LED Indicator for Valid Power and Network Sync
- Operation from PoE Power (Class 0, IEEE 802.3af)
- Equipped for SysFlex™ Rack Mounting or Surface Mounting



The SysFlex series is a family of A/V modules providing complex interface solutions at the click of a connector. SysFlex modules provide connectorized interface between data networks and analog and digital audio devices, networked and conventional amplifiers and other application-specific solutions. In RDL's tradition of versatility, SysFlex modules can be used right where they are needed: Rack-mounted, Surface-mounted, or unmounted. They are light-weight, compact and easy to install with simple, straightforward switch settings and LED indicators. Modules quickly snap into the SysFlex rack mount and each is firmly secured with a single screw. The racking system segregates network and power wiring from the audio and digital audio connectors. For connectorized network audio endpoints and A/V system components that provide unparalleled performance and advanced features without giving up simplicity and ease of installation, SysFlex is the industry's best value.

**APPLICATION:** The SF-DN4 is a digital audio interface that converts two stereo digital audio sources to four Dante network audio channels. The SF-DN4 automatically detects a valid input on any of the three input jacks: S/PDIF optical, S/PDIF coaxial, or AES/EBU XLR. The input is decoded, re-clocked and transmitted to the Dante network. A yellow front-panel LOCK LED indicates a valid source received without any lock errors. Special software is not required to configure the module. The SF-DN4 is a professional grade product for studio quality performance. The SF-DN4 is PoE powered. Valid PoE power and synchronization to the Dante network is indicated by a green LED visible from the front of the unit.

The SF-DN4 is constructed in a durable, professional all-metal enclosure suitable for free-standing, surface-mounted or rack-mounted operation. This full-featured SYSFLEX product is engineered and manufactured in the U.S.A for continuous duty in demanding installations. The versatility of SYSFLEX products adds enormous flexibility in the design and installation of professional A/V systems.

# Model SF-DN4

## Digital Audio to Network Interface

# Installation/Operation

**CE** Declaration of Conformity available from rdlnet.com.  
Sole EMC specifications provided on product package.  
Specifications are subject to change without notice.

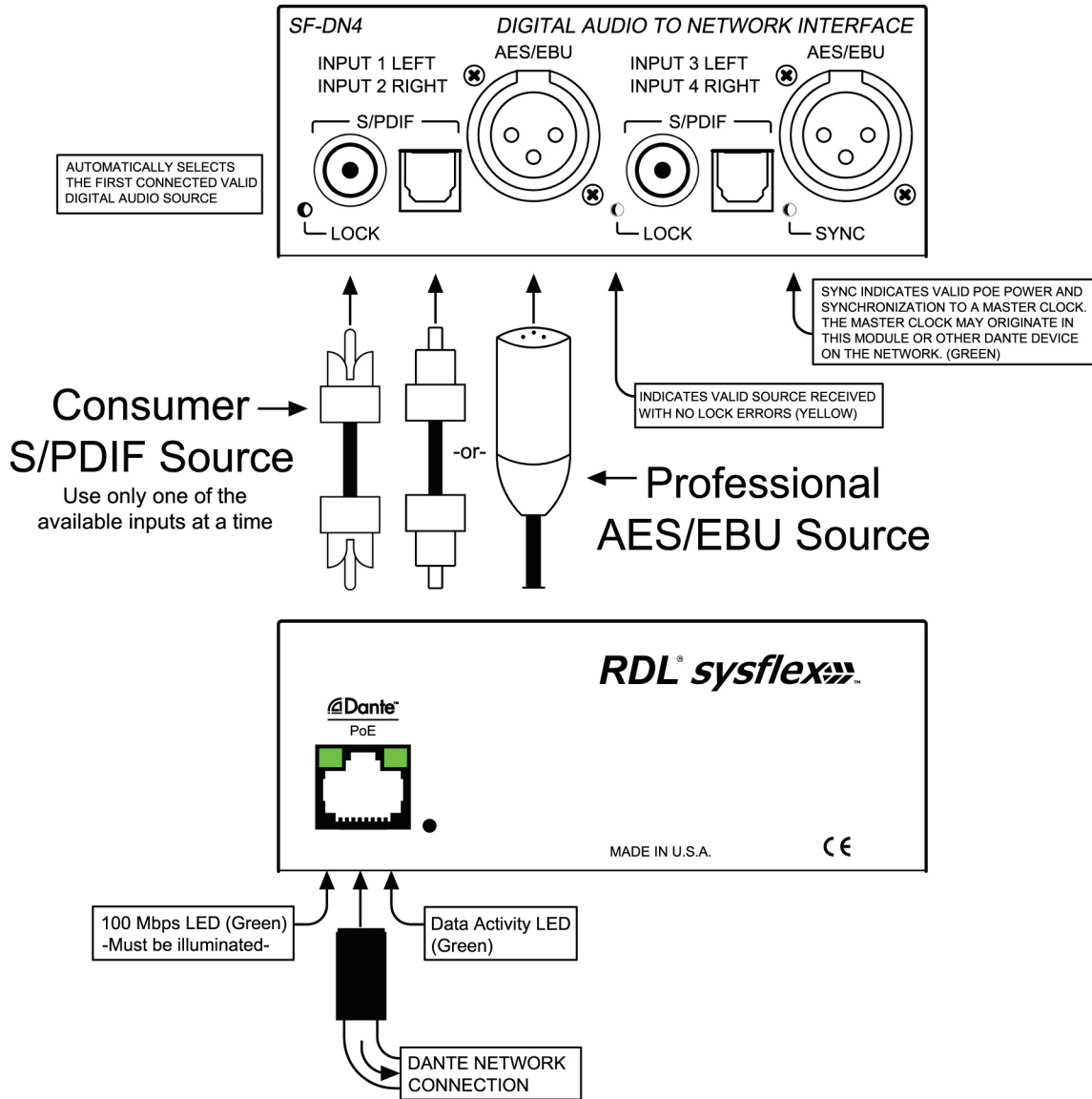

### TYPICAL PERFORMANCE

Network Connector: RJ45 with Link and Speed indicators

Digital Audio Ethernet Protocol: Dante

Transmission Rate: 100 Mbps

Input Sample Rates Supported: 32 kHz to 192 kHz

Output (Dante) Sample Rates Supported: 44.1 kHz, 48 kHz (default), 88.2 kHz, 96 kHz

Bit Depth Supported: 24 bits

Inputs (6): 110 Ω AES/EBU XLR, transformer isolated (2); 75 Ω S/PDIF RCA jack (2); S/PDIF optical (2)

Indicators (5):

Ambient Operating Environment:  
Power Requirement:  
Dimensions:

Package Type:  
Package Dimensions:  
Shipping Weight:  
WEEE weight:  
Tariff code:

Ethernet Link and Speed (2, rear panel);  
Sync (front panel); Lock (2, front panel)  
0° C to 50° C  
PoE Class 0, IEEE 802.3af  
4.23" (10.74 cm) W; 1.68" (4.27 cm) H;  
5.77" (14.66 cm) D  
Cardboard Box  
7 x 4.375 x 2.25 in.  
1.375 lbs.  
0.16 lbs.  
8517.18.0050

Radio Design Labs Technical Support Centers

U.S.A. (800) 933-1780, (928) 778-3554; Fax: (928) 778-3506

Europe [NH Amsterdam] (+31) 20-6238 983; Fax: (+31) 20-6225-287